



PQ06P01

Two-hand control station



DEFINITION OF TWO HAND CONTROL (UNI EN 292/1 ITEM 3.23.4)

3.23.4

Two hand control: maintained action control which requires at least the simultaneous activation of the two manual controls (actuators) to start up and continue running the machine and its elements, thus ensuring that operators are protected.



PRESENTATION

The PQ06P01 requires at least a synchronous action by both hands to release and maintain the operation of a machine or machine elements as long as there are dangerous situations, assuring in this way only the protection of this operator.

MAIN FEATURES

- Standards: IEC/EN 60947/3
- Self-extinguishing V0 UL94 case with protective cover on side buttons.
- Available with M16 / M20 / M23 cable entry.
- Protection class (IEC/EN 60529): IP65.
- Customized versions available on request.

PUSH BUTTONS

Two-hand controls

Two green pushbuttons $\varnothing 40$ mm (mushroom type) with contact block (1NO).

Emergency Stop device

One red emergency stop pushbutton $\varnothing 40$ mm (mushroom type), twist to release with vision for unlocking, self-monitored contact block (NO-NC-NO), delivered with $\varnothing 60$ mm Emergency Stop label, yellow and English black letters (others languages under request).

Other push buttons

Two $\varnothing 22.5$ mm white light buttons (with nameplate and nameplate holder) with contact blocks (Lampholder with build-in LED, AC/DC 12 V + 1NO).





PQ06P01

Two-hand control station
Totally customizable

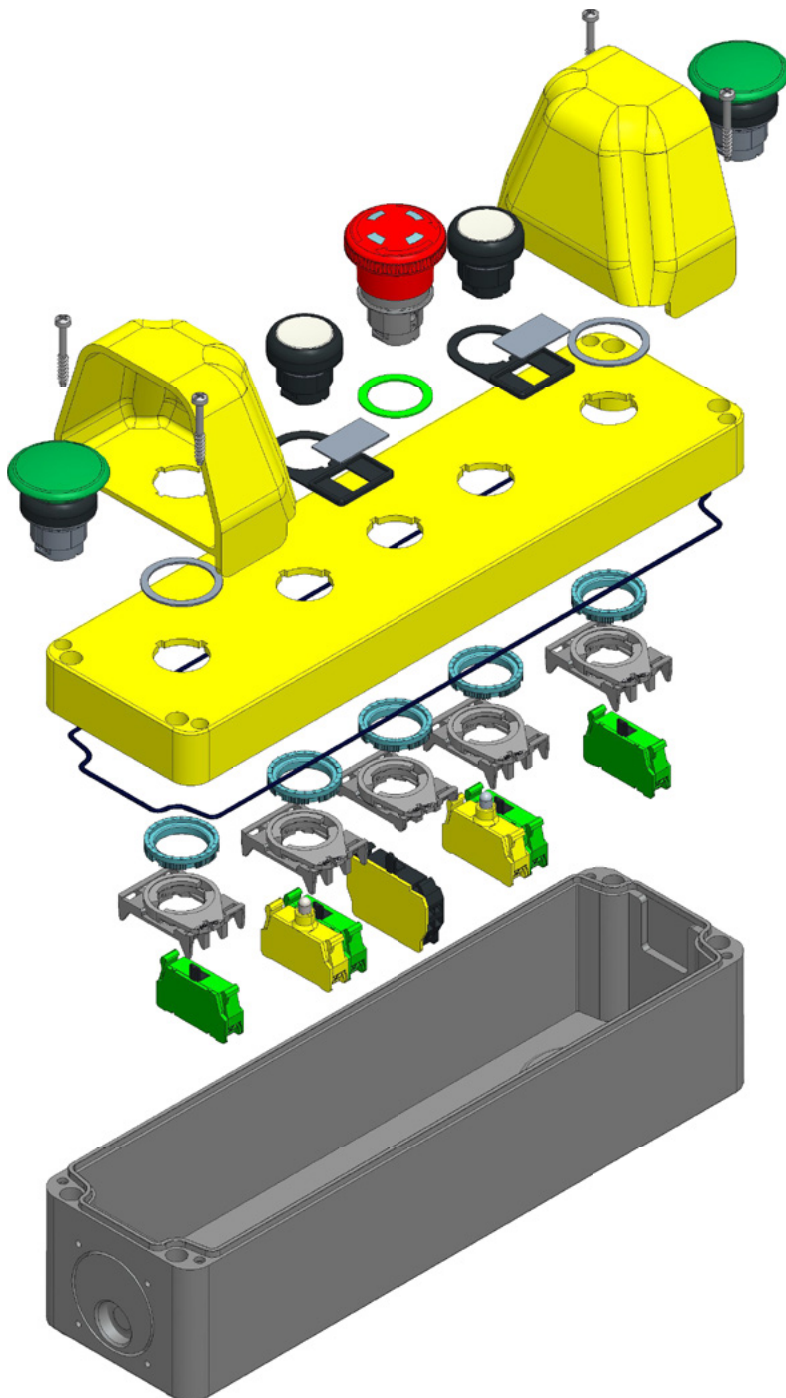

STANDARD COMPOSITION

Box with 6-hole lid with 2 covers for hand protection

2 momentary green mushroom buttons Ø40 mm + contact element 1NO

1 red mushroom button for emergency stop Ø40 mm, with rotary release with vision + self-monitoring contact element NO-NC-NO

2 white luminous push buttons Ø22.5 mm + lamp holder with integrated LED, AC/DC 12V and contact element 1NO



PCW10

Spring clamp terminal (NO)



PCW010SS

Self-monitored contact (NO-NC-NO)

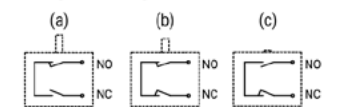
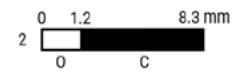
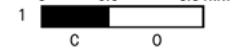

PCW5L12

Lampholder with built-in LED,
 AC/DC 12 V power supply
 X1 — X2

